



**HIMACHAL PRADESH HORTICULTURAL PRODUCE MARKETING  
AND PROCESSING CORPORATION LIMITED  
(GOVERNMENT OF HIMACHAL UNDERTAKING)  
HEAD OFFICE: 3<sup>RD</sup> FLOOR, NIGAM VIHAR: SHIMLA-171002  
PH: 0177-2623835, 2623832 FAX: 2623834**

**NOTICE INVITING TENDER FOR SEALED BIDS/OPEN AUCTION**

Sealed Bids are invited on behalf of the Himachal Pradesh Horticultural Produce Marketing & Processing Corporation Limited (HPMC) from the interested parties for the **OUTRIGHT PURCHASE OF HPMC LAND** measuring 2.05 acres (89,298 Sq. ft) in Chennai at Numbal Village, Ambattur Taluka, District Thiruvallur, Chennai South, Tamilnadu. The property is for outright sale on "As is where is basis". The property and title deeds can be inspected on any working day by contacting Shri Amrish Kumar, Regional Manager Phone Nos. 044-25735533, 25733359. The sealed bids should reach the Office of The Regional Manager, HPMC, 34/1, A-3, Ennore Express High Road, Thirvottiyur, Chennai - 600019 on or before 14.00 hrs. on Tuesday the **29<sup>th</sup> November 2011**. The bids so received shall be opened at 15.00 hrs on the same day in the presence of participants or their representatives. The sealed bids should be accompanied by EMD in the shape of demand draft amounting to Rs. 25.00 lacs (Rs. Twenty five lacs only) drawn in favour of HPMC, issued by any scheduled commercial bank payable at Chennai without which bid would be rejected outrightly. The detailed terms and conditions for the sale can be obtained from the Corporate Office of HPMC at Nigam Vihar, Shimla - 171002 or can also be downloaded from the websites: <http://hpmc.nic.in> or <http://himachal.nic.in> or [www.ifcilttd.com](http://www.ifcilttd.com) or [www.himcon.org](http://www.himcon.org) with regard to the sale process, the decision of HPMC will be final and binding and not to be challenged.

**MADAN CHAUHAN  
MANAGING DIRECTOR**



**HIMCAHAL PRADESH HORTICULTURAL PRODUCE MARKETING  
AND PROCESSING CORPORATION LIMITED**

**(A GOVERNMENT UNDERTAKING)**

**HEAD OFFICE: 3<sup>RD</sup> FLOOR, NIGAM VIHAR: SHIMLA-171002**

**PH: 0177-2623835, 2623832 FAX: 2623834**

**DETAILS OF LAND**

1. The prime land having total area of plot is 2.05 acres (89,298 sq. ft.) near International Airport, Chennai
2. The land is situated at Numbal Village, Ambattur Taluk, District Thiruvallur, Chennai South (Tamilnadu) at a distance of 17 kms from Chennai, Parris Corner.
3. The land comprises of Survey No.61/2 and 61/7A 1A2 Numbal Village on Chennai – Poona Mallee High Road.
4. The property area is surrounded by Commercial and Residential properties and may be used for industrial or residential purposes as per applicable laws.
5. The advantage of land is because it is near to six lanes Chennai-Bangalore National Highway.

**TERMS AND CONDITIONS FOR SALE OF HPMC LAND AT CHENNAI**

6. The land is for sale on "As is where is basis" with present land use pattern
7. The reserve price of the land is Rs. 16.00 crore (Rs. Sixteen Crores only).
8. The bidder shall have to deposit EMD of Rs. 25.00 lacs along with offer. The offers without EMD will be rejected. The EMD of unsuccessful bidders will be returned on the date of opening of the bids on the spot.
9. HPMC reserves the right to annul the process in case of inadequate response and may opt for open bidding process on the same day at 15:30 hours. The Bidders will have to deposit EMD as above for participating in open bidding.
10. The highest bidder on acceptance of bid shall have to deposit as under:
  - a. 25% bid amount within seven days,
  - b. 50% within 30 days from the date of communication of acceptance of bid,
  - c. Balance 25% to be deposited at the time of registration failing which the amount so deposited shall be forfeited.

**MANAGING DIRECTOR**

SKETCH SHOWING THE LAND IN SURVEY NO. 61/2 AND 61/7 OF NOOMBAL VILLAGE OF SAIDAPET TALUK  
 KIND ATTENTION - M.D. - HIMCONS.

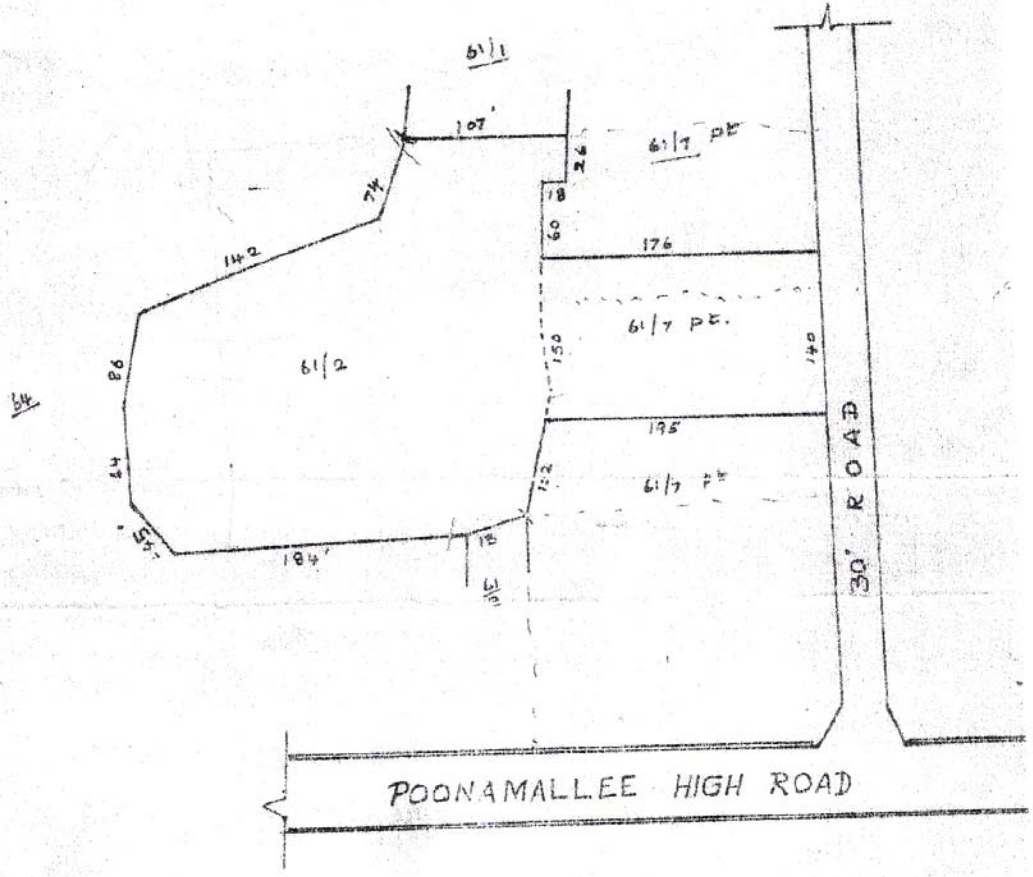

EXTENT

UPAYA KUMAR :	S.No. 61/2 =	1.43 Acre.	NEW NO.	61/2	OLD NO.	15/3, 17/4
RAMAMURTHY :	S.No. 61/7 PE =	0.62 Acre.		61/7		15/7, 8
		<u>2.05</u>				8, 38 am old
						688, 689 A

Not to Scale.